

# Installation Guide

Accumulator Tank/Pulsation Dampener  
Models: ACT820-JG and ACT820-NPT

## Features and Benefits:

- Convenient 3/8" Female NPT or 3/8" John Guest porting options
- Optional 3/8" NPT x 1/2" NPS fitting available
- Compact design fits in small spaces
- Dampens pump switch cycling/pulsations
- Limits harmful spikes/water hammer
- Minimizes hydraulic noise
- NSF food grade materials
- Easy to install and maintain
- Mounts in any position with included bracket



## Specifications:

**Description** – Food-grade pressurized fluid holding tank/pulsation dampener (accumulator tank). Tank can be installed in a demand pump driven fluid system to reduce pulsations from switch cycles. This smooths flow, extends switch life and reduces noise.

**Maximum Working Pressure** – 125 PSI

**Wetted Materials** – Nylon, Butyl

**Internal Volume** – 28 ounces

**Pre-Charge** – 20 PSI

**Dimensions** – See page 2

**Weight** – 1 lb.

**Note:** This tank is not intended for use in systems with variable speed pumps

**Tank Pre-Charge:** The gas side of the tank is pre-charged to 20 PSI. Pressure should be checked periodically. To check tank pre-charge, open a tap to discharge water pressure. Then use a standard tire gauge to check pre-charge at the gas fill valve. The pre-charge can be adjusted to suit a particular application, but should not exceed 20 PSI.

**Winterizing:** Before exposure to freezing temperatures, all water must be drained, or replaced with potable water anti-freeze. Use of automotive anti-freeze is prohibited as serious injury or death may occur.

# Installation Guide

Accumulator Tank/Pulsation Dampener  
Models: ACT820-JG and ACT820-NPT

## DIMENSIONS

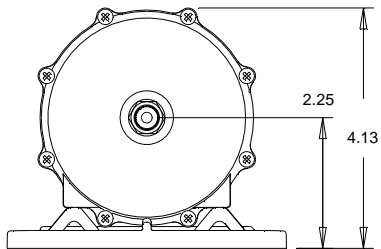
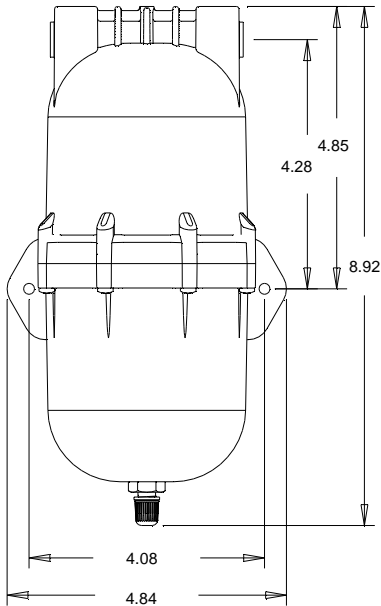

## TYPICAL INSTALLATION

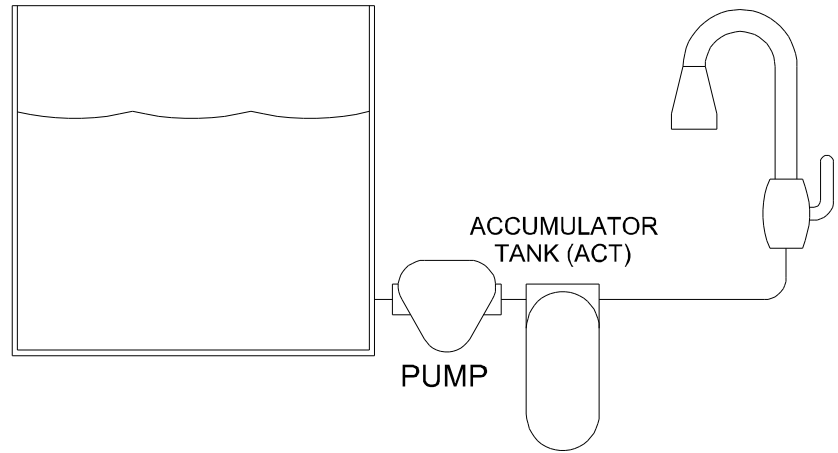

## TROUBLESHOOTING:

**Leakage from fittings** – Check that tubing is fully inserted into JG cartridges, or threaded fittings are appropriately taped and torqued on NPT ports.

**Leakage from fill valve** – Diaphragm has reached end-of-life. Replace accumulator tank

**Pump switch cycles rapidly** – Check for appropriate air pre-charge

**Tank not holding air pressure** – Loose screws or fill valve, or diaphragm has reached end of life. Replace accumulator tank.

**Warranty:** Aquatec warrants this product to be free of manufacturing/material defects for a period of 13 months after shipping date from Aquatec. Warranty is limited to product repair or replacement, at Aquatec's discretion. Warranty returns must be pre-approved with an authorization (RMA) number from Aquatec.