

# 58-FC1-220

## 220 PSI, 115VAC FLOOR CARE PUMP

Flow : With #2 Nozzle: 180 PSI, .4 GPM  
 With #6 Nozzle: 100 PSI, .85 GPM

### FEATURES:

Series 5800 Pump  
 Floor Care Applications  
 115 VAC Operation  
 3/8" NPT Female Ports  
 Pressure Switch Set to 220 PSI  
 Internal Pressure Bypass  
 Sealed Motor to Prevent Moisture Intrusion  
 Steel Mounting Plate (Other Types Available)

### SPECIFICATIONS:

- MOTOR:**  
 TYPE: 115 VAC, 60 HZ, Permanent Magnet, Totally Enclosed, Non-Ventilated  
 LEADS: 18 AWG, 12" LONG  
 TEMP. LIMITS: For User Safety, Optimal Performance, and Maximum Motor Life, This Motor is Equipped with a Thermal Protector that Limits the Motor Shell Temperature to 145°F (63°C), as Shown on the Heat Rise Graph.
- DUTY CYCLE:** See Heat Rise Graph
- PUMP DESIGN:** 3 Chamber Diaphragm Pump, Self Priming, Capable of Being Run Dry
- TYPICAL APPLICATION:** Floor Care
- MATERIALS:**  
 HOUSINGS: Nylon  
 VALVES: Viton  
 DIAPHRAGM: Santoprene  
 FASTENERS: Stainless Steel, Zinc Plated Carbon Steel
- LIQUID TEMPERATURE:** 170°F (77°C) Max.
- PUMP CERTIFICATIONS:** UR E225352 (5883-2M61-0584-UR)
- PRIMING CAPABILITIES:** 9 Feet

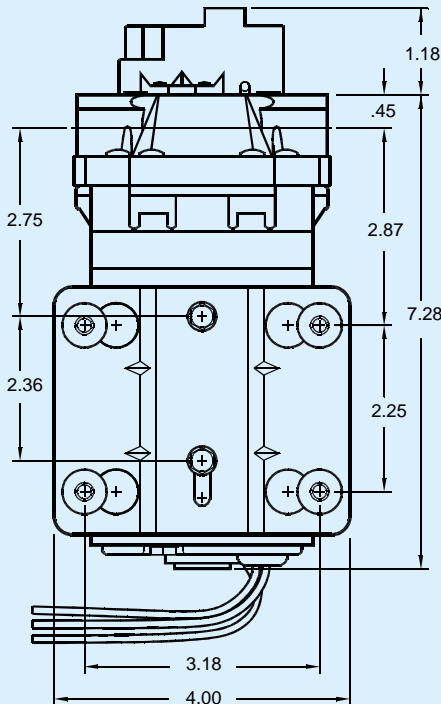
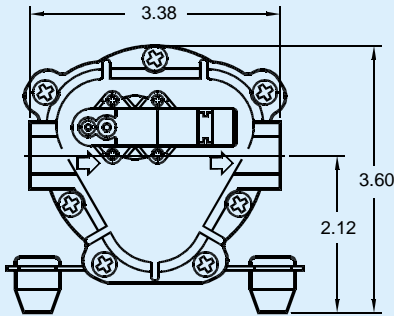

WEIGHT: 6 lbs.



Aquatec Water Systems, Inc.  
 17422 Pullman  
 Irvine, CA 92614  
 Sales: 949-225-2200  
 Fax: 949-225-2222

DOCUMENT: DS58-FC1-220  
 ISSUED: 3/26/10  
 REVISED: 3/26/10

PRELIMINARY; SPECIFICATIONS SUBJECT TO CHANGE

# 58-FC1-220

## 220 PSI, 115VAC FLOOR CARE PUMP

PERFORMANCE DATA			
NOZZLE SIZE	DISCHARGE PRESSURE (PSI)	FLOW (GPM)	CURRENT (AMPS)
NUMBER 2	180	0.40	1.50
NUMBER 6	100	0.85	1.20

PERFORMANCE MEASURED WITH FLOODED INLET (0 PSI), 70°F (21°C) AMBIENT AND WATER TEMPERATURE, AND VOLTAGE CONTROLLED AT 115 VAC. POSITIVE INLET PRESSURE WILL INCREASE THE DISCHARGE PRESSURE BY A SIMILAR AMOUNT, FOR A GIVEN FLOW. MAXIMUM INLET PRESSURE IS 60 PSI.

**NOTES:**

- NOT RECOMMENDED FOR NOZZLES SMALLER THAN NUMBER TWO
- REQUIRES MINIMUM SYSTEM PRESSURE RELIEF VALVE SETTING OF 300 PSI WITH HEATER EQUIPPED UNITS

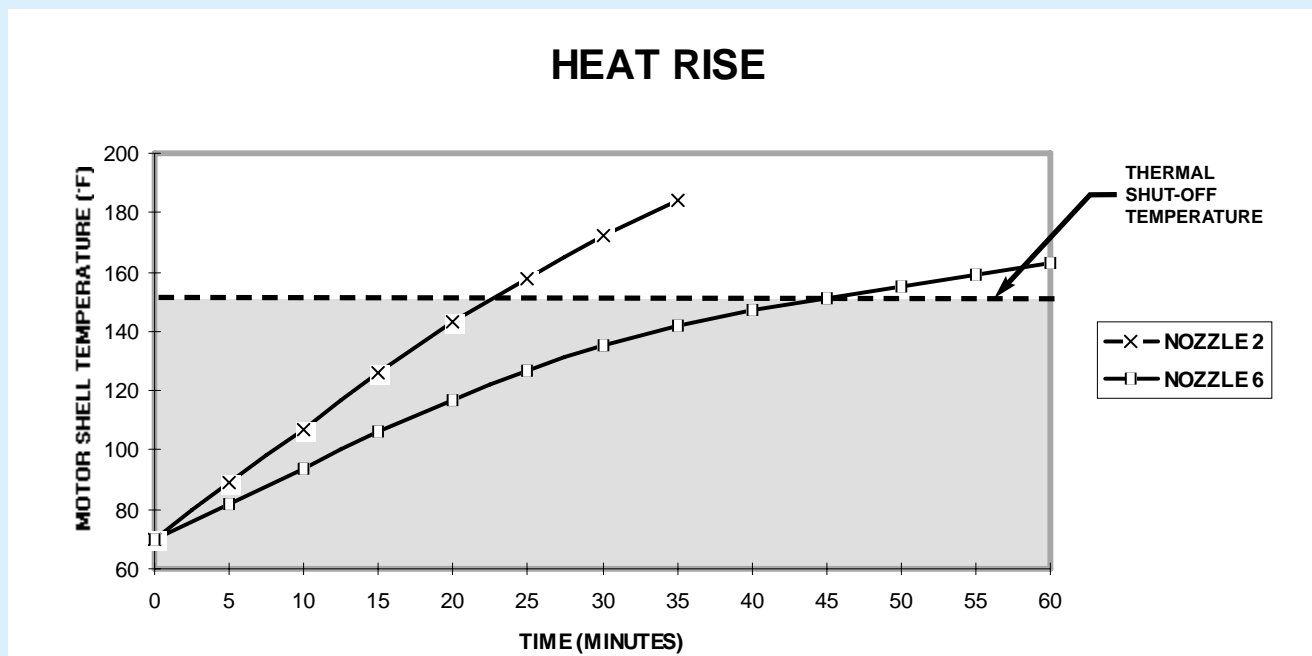

The motor driving this pump has a built in thermal protector that will open, shutting off the pump, when the surface temperature of the motor heats to approximately 150°F. Motors of this size and construction require 15 to 30 minutes of cooling time before the thermal protector closes and re-energizes the pump. Lower current levels heat more slowly, allowing longer run times, but the cool down time still averages about 30 minutes, at 70°F ambient temperature.

ALL PERFORMANCE AND HEAT RISE FIGURES ARE APPROXIMATE. ACTUAL VALUES WILL VARY WITH AMBIENT CONDITIONS.