

Series 5800 Pump

Model: 58XX-XX01-B594

Flow Range: Open Flow = .50-.71 GPM

At 130 PSI = .01-.23 GPM

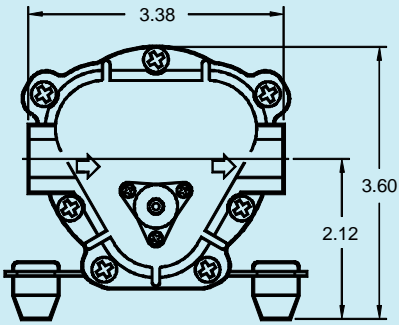

COMPLETING THE PART NUMBER:

58XX-XX01-B594

Steel Mounting Plate (Other Types Available)

Desired Shut-off Pressure & Code

0 = None D = 50PSI H = 90PSI L = 130PSI

A = 30PSI E = 60PSI I = 100PSI

B = 40PSI F = 70PSI J = 110PSI

C = 45PSI G = 80PSI K = 120PSI

See Performance Data for Recommended By-pass Pressure and Code

Pressure Control Options

0 = No Control (Waiver Required)

1 = Pressure Switch Control (Select Desired Shut Off Pressure)

2 = Pressure Relief Valve (Select Recommended By-Pass Pressure)

Select Pumphead Model From Performance Data Chart

3 = Open Ports for 3/8" Compression Fitting

5 = Push-to-Connect Ports for 3/8" Tubing

SPECIFICATIONS:

MOTOR:

TYPE:

24 VDC, 60 HZ, Permanent Magnet,
Totally Enclosed, Non-Ventilated

LEADS:

14 AWG, 12" LONG

TEMP. LIMITS:

For User Safety, Optimal Performance, and
Maximum Motor Life, This Motor is Equipped with a
Thermal Protector that Limits the Motor Shell
Temperature to 145°F (63°C), as Shown on the Heat
Rise Graph.

DUTY CYCLE:

See Heat Rise Graph

PUMP DESIGN:

3 Chamber Diaphragm Pump, Self Priming,
Capable of Being Run Dry

TYPICAL APPLICATION:

Industrial Grade Water Transfer

MATERIALS:

HOUSINGS:

Nylon

VALVES:

EPDM

DIAPHRAGM:

Santoprene

FASTENERS:

Stainless Steel

LIQUID TEMPERATURE:

170°F (77°C) Max.

PUMP CERTIFICATIONS:

NSF Standard 58

PRIMING CAPABILITIES:

	58X0	58X1	58X2	58X3
PRIME (FEET)	5	6	7	9

FITTINGS:

TYPE	SHAPE	KIT NO.	CONNECTS TO...
3/8" COMPRESSION	STRAIGHT	25-145	3/8" TUBING
3/8" COMPRESSION	ELBOW	25-146	3/8" TUBING
3/8" STEM	STRAIGHT	25-144	3/8" JOHN GUEST PUSH-ON FITTING

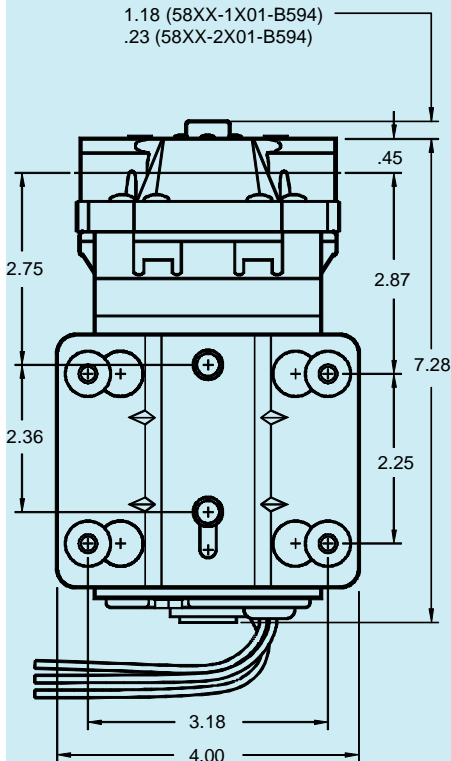

WEIGHT: 6 lbs.



Aquatec Water Systems, Inc.
17422 Pullman
Irvine, CA 92614
Sales: 949-225-2200
Fax: 949-225-2222

DOCUMENT:
ISSUED:
REVISED:

DS58XX-XX01-B594
12/17/00
12/17/00

Series 5800 Pump

Model: 58XX-XX01-B594

PERFORMANCE DATA										
DISCHARGE PRESSURE (PSI)	PUMPHEAD MODEL								RECOMMENDED BY-PASS PRESSURE	
	58X0		58X1		58X2		58X3		PSI	CODE
	FLOW (GPM)	CURRENT (AMPS)	FLOW (GPM)	CURRENT (AMPS)	FLOW (GPM)	CURRENT (AMPS)	FLOW (GPM)	CURRENT (AMPS)		
130	0.01	1.15	0.14	1.37	0.17	1.75	0.23	2.15	160	P
120	0.04	1.10	0.16	1.30	0.20	1.67	0.29	2.04	150	N
110	0.08	1.07	0.21	1.22	0.24	1.58	0.37	1.89	140	M
100	0.12	1.03	0.23	1.14	0.29	1.47	0.43	1.75	130	L
90	0.13	0.99	0.26	1.06	0.35	1.35	0.48	1.61	120	K
80	0.22	0.92	0.30	0.99	0.40	1.24	0.51	1.49	110	J
70	0.30	0.85	0.33	0.90	0.43	1.13	0.55	1.37	100	I
60	0.33	0.77	0.36	0.83	0.46	1.02	0.58	1.22	90	H
50	0.35	0.70	0.37	0.74	0.49	0.91	0.60	1.09	80	G
40	0.37	0.62	0.39	0.65	0.50	0.79	0.61	0.96	70	F
30	0.39	0.53	0.40	0.56	0.52	0.68	0.64	0.83	70	F
20	0.42	0.45	0.43	0.47	0.56	0.55	0.67	0.69	70	F
10	0.45	0.35	0.47	0.37	0.60	0.41	0.73	0.53	70	F
OPEN	0.50	0.32	0.51	0.34	0.62	0.38	0.71	0.55	70	F

PERFORMANCE MEASURED WITH FLOODED INLET (0 PSI), 70°F (21°C) AMBIENT AND WATER TEMPERATURE, AND VOLTAGE CONTROLLED AT 24 VDC. POSITIVE INLET PRESSURE WILL INCREASE THE DISCHARGE PRESSURE BY A SIMILAR AMOUNT, FOR A GIVEN FLOW. MAXIMUM INLET PRESSURE IS 60 PSI.

SHADED AREA DENOTES CONTINUOUS OPERATION CAPABILITY AT DESIGNATED PRESSURE AND CURRENT.

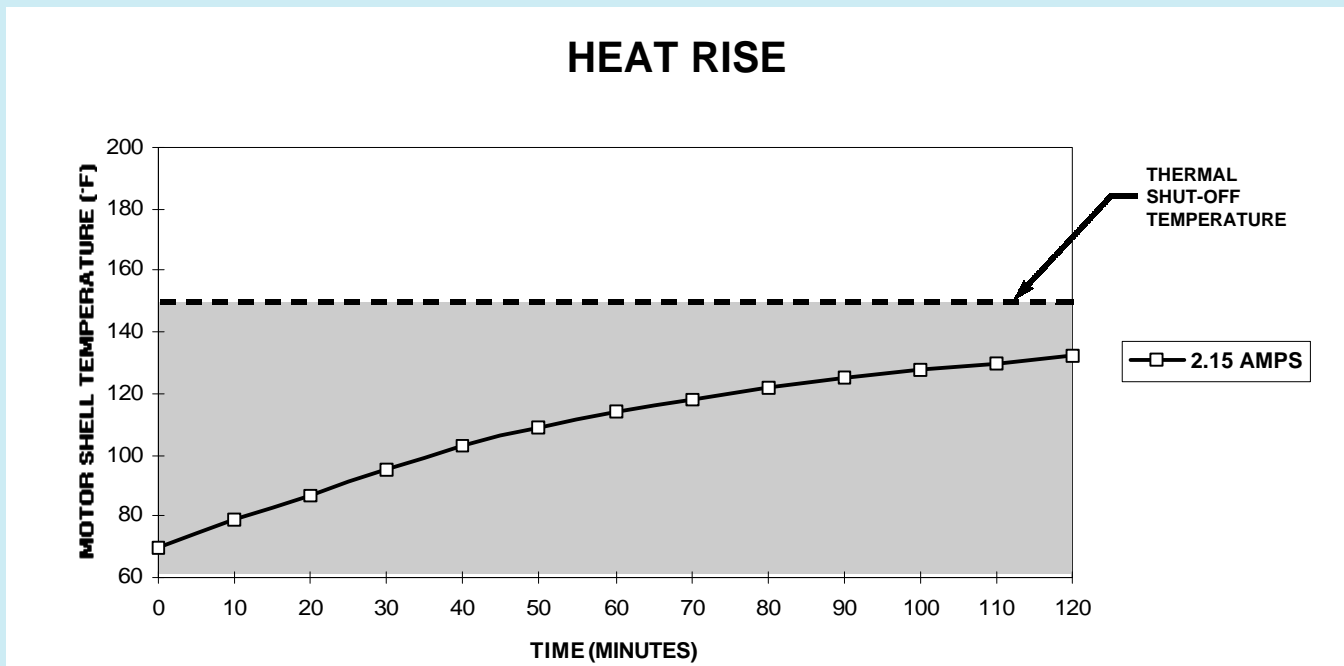

All of the pump models in the Performance Data and Heat Rise charts are in the shaded area, meaning they are capable of sustaining continual running, at any of the above listed pressures, without shutting down to allow the motor to cool. To conserve wearing parts, however, the pump should only operate as needed.

ALL PERFORMANCE AND HEAT RISE FIGURES ARE APPROXIMATE. ACTUAL VALUES WILL VARY WITH AMBIENT CONDITIONS.