

Whenever you need to know actual operating pressure, Aquatec's stand-alone Pressure Transducers offer an effective, economical approach. These devices offer true linear pressure sensing capabilities in a compact, robust housing. They can either be used with a digital display, connected to a circuitboard, or connected directly to a controller card.

Our Transducers come with a strained relief, 6 foot long leadwire and have a typical operating range of 0-100 PSI.

Porting is a flow-through design and available with John Guest "quick connect" fittings for 1/4", 5/16" (8mm), and 3/8" tubing. The 4 wire system provides linear low level output from a piezoresistive strain gauge. A proportional voltage output is generated which represents the measured pressure.

- **NSF Approved**
- **Flow-Through Design (i.e. no "Dead Legs")**
- **1-100 PSI Sensing Capability**
- **0-150 mV Output**

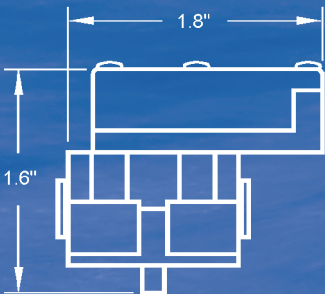
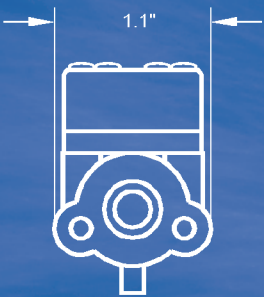

**TECHNICAL SPECIFICATIONS:**

WETTED MATERIALS:	Polypropylene, Santoprene, EPDM
POWER REQUIREMENTS	3-12VDC
DIMENSIONS AND WEIGHT:	Approx 2" x 1" x 1", 4 oz.
PROOF PRESSURE	150 psi
SENSITIVITY:	.25mV/V/psi
LINEARITY AND HYSTERESIS:	5%
INPUT RESISTANCE:	4.1 kOHMs

# 550 SERIES, 50 PSI

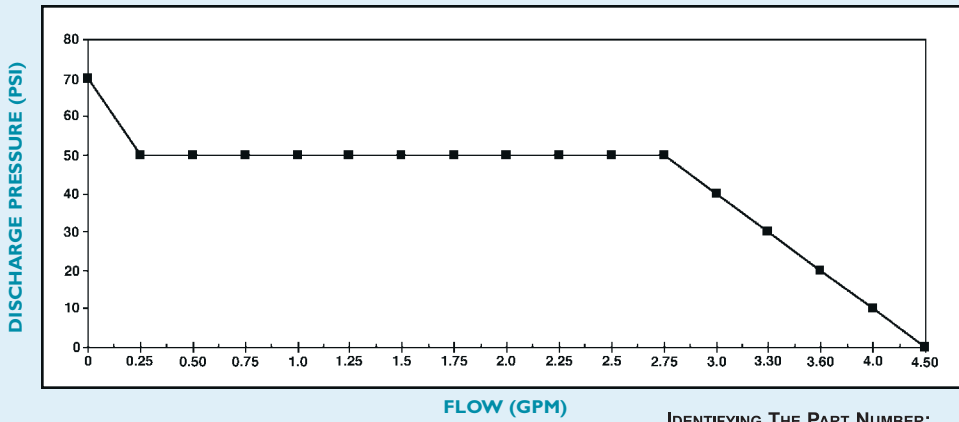

**IDENTIFYING THE PART NUMBER:**

- 5502-IDN2-V77D
- BASEPLATE AS SHOWN
- 115VAC MOTOR
- EMIRFI NOISE SUPPRESSION
- BEVERAGE AND DRINKING WATER DELIVERY
- NSF OR FDA LISTED MATERIALS
- PRESSURE REGULATED AT 50 PSI
- PRESSURE SENSING MOTOR CONTROLLER
- 3.0 DEGREE CAM
- QUICK DISCONNECT PORT
- SERIES 550 PUMP

# 5800 SERIES, 60 PSI

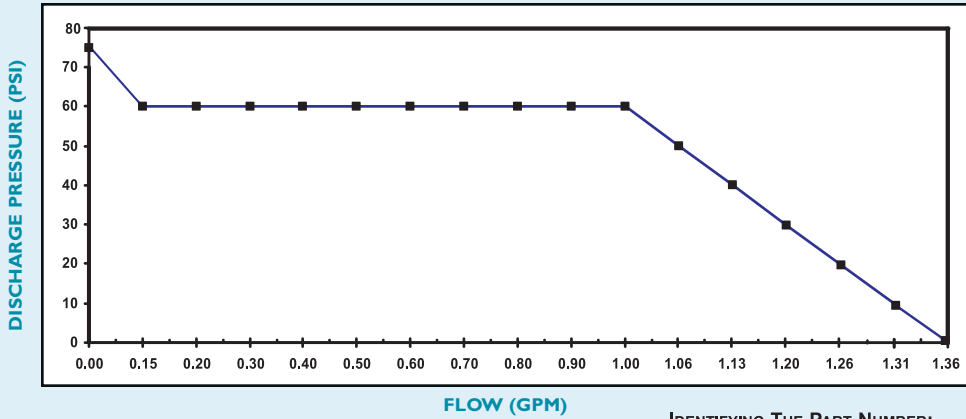

**IDENTIFYING THE PART NUMBER:**

- 5853-GE12-V81D
- BASEPLATE AS SHOWN
- 115VAC MOTOR
- EMIRFI NOISE SUPPRESSION
- BEVERAGE AND DRINKING WATER DELIVERY
- NSF OR FDA LISTED MATERIALS
- PRESSURE REGULATED AT 60 PSI
- PRESSURE SENSING MOTOR CONTROLLER
- 3.5 DEGREE CAM
- PUSH-TO-CONNECT PORTS FOR 3/8" TUBING
- SERIES 5800 PUMP

# 5800 SERIES, 40 PSI

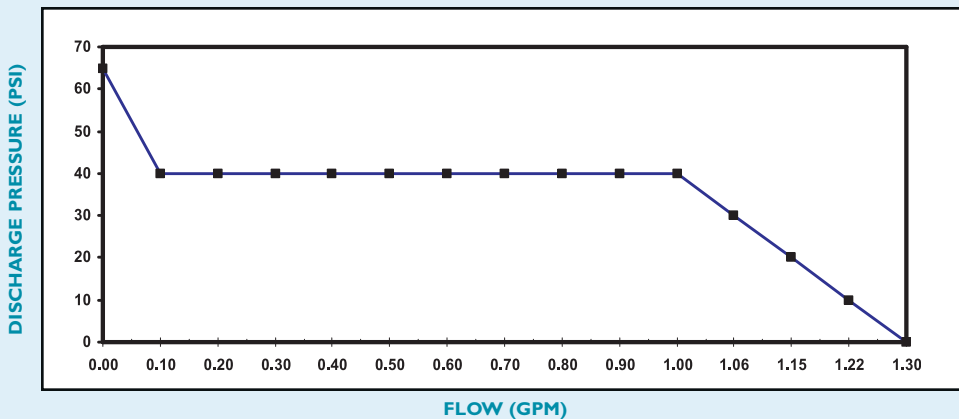

**IDENTIFYING THE PART NUMBER:**

- 5853-GB12-V81D
- BASEPLATE AS SHOWN
- 115VAC MOTOR
- EMIRFI NOISE SUPPRESSION
- BEVERAGE AND DRINKING WATER DELIVERY
- NSF OR FDA LISTED MATERIALS
- PRESSURE REGULATED AT 60 PSI
- PRESSURE SENSING MOTOR CONTROLLER
- 3.5 DEGREE CAM
- PUSH-TO-CONNECT PORTS FOR 3/8" TUBING
- SERIES 5800 PUMP

# DIAPHRAGM PUMPS

